

NEWPORT ON THE LEVEE

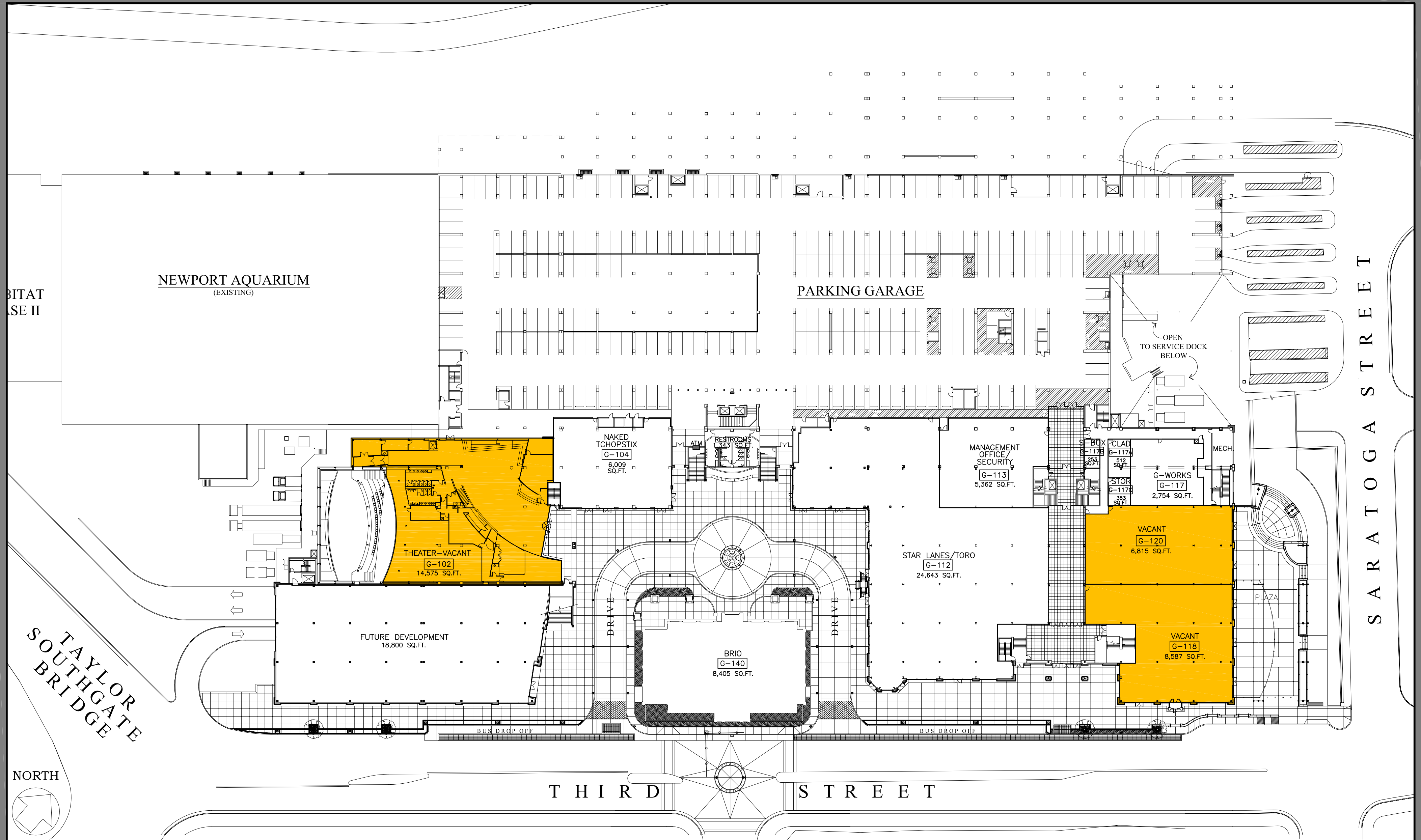

May 2011

PLAZA LEVEL LEASING PLAN

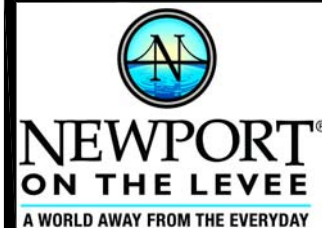

NEWPORT ON THE LEVEE
NEWPORT, KENTUCKY

MANAGEMENT OFFICE
1 LEVEE WAY SUITE 1113
NEWPORT, KY 41071
TEL 614.414.7300
FAX 859.291.7020

OWNER
THE PRICE GROUP
7979 IVANHOE AVE SUITE 550
LAJOLLA, CA 92037
TEL 858.373.2064
FAX 858.454.4230

DESIGN ARCHITECT
DEVELOPMENT DESIGN GROUP, INC.
7 ST. PAUL STREET
BALTIMORE, MD 21202
TEL 410.962.0506
FAX 410.783.0816

PROJECT ARCHITECT
GBBN ARCHITECTS
332 EAST 8TH STREET
CINCINNATI, OH 45202
TEL 513.241.8700
FAX 513.241.8873
www.gbbn.com

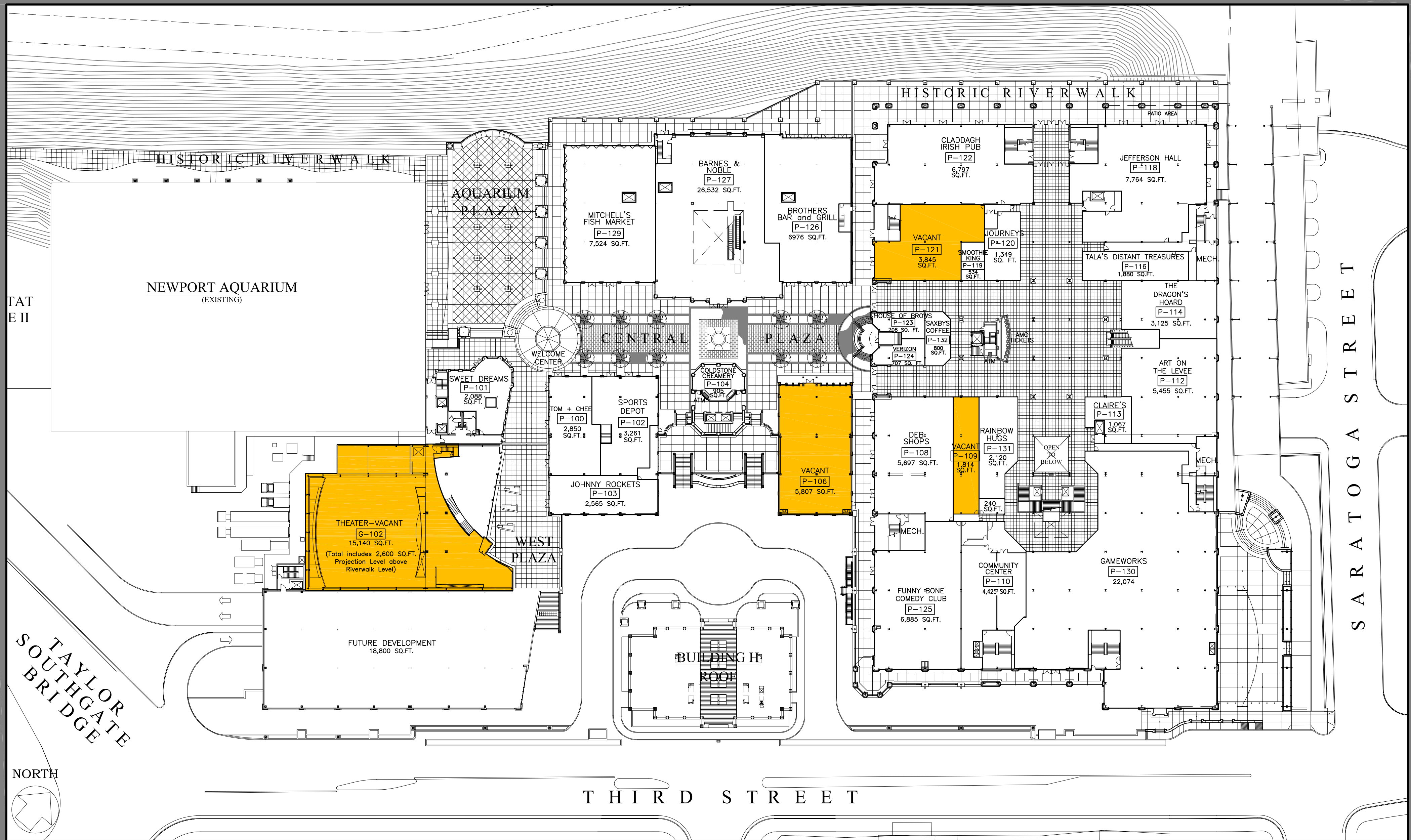

May 2011

RIVERWALK LEVEL LEASING PLAN

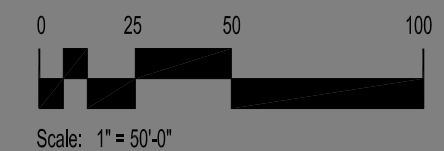

NEWPORT ON THE LEVEE
NEWPORT, KENTUCKY

MANAGEMENT OFFICE

1 LEVEE WAY SUITE 1113 TEL 614.414.7300
NEWPORT, KY 41071 FAX 859.291.7020

OWNER

THE PRICE GROUP TEL 858.373.2064
7979 IVANHOE AVE SUITE 550 FAX 858.454.4230
LAJOLLA, CA 92037

DESIGN ARCHITECT

DEVELOPMENT DESIGN GROUP, INC. TEL 410.962.0506
7 ST. PAUL STREET FAX 410.783.0816
BALTIMORE, MD 21202

PROJECT ARCHITECT

GBBN ARCHITECTS TEL 513.241.8700
332 EAST 8TH STREET FAX 513.241.8873
CINCINNATI, OH 45202 www.gbbn.com

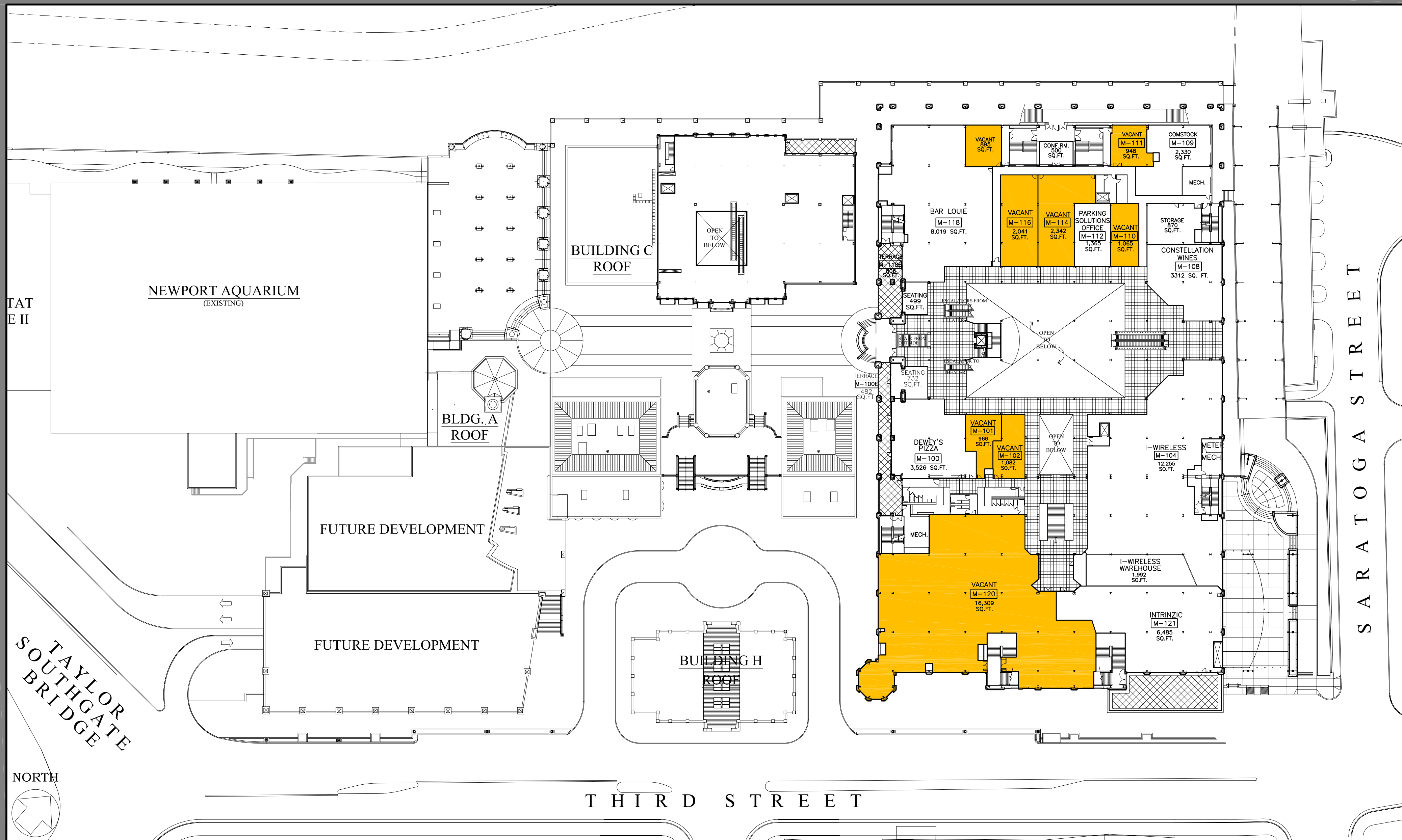

May 2011

MEZZANINE LEVEL LEASING PLAN

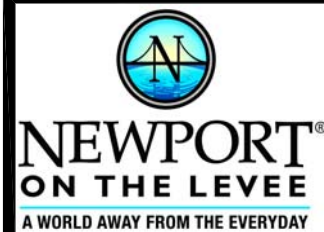
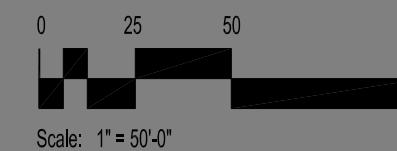

NEWPORT ON THE LEVEE
NEWPORT, KENTUCKY

MANAGEMENT OFFICE
1 LEVEE WAY SUITE 1113
NEWPORT, KY 41071
TEL 614.414.7300
FAX 859.291.7020

OWNER
THE PRICE GROUP
7979 IVANHOE AVE SUITE 550
LAJOLLA, CA 92037
TEL 858.373.2064
FAX 858.454.4230

DESIGN ARCHITECT
DEVELOPMENT DESIGN GROUP, INC.
7 ST. PAUL STREET
BALTIMORE, MD 21202
TEL 410.962.0506
FAX 410.783.0816

PROJECT ARCHITECT
GBBN ARCHITECTS
332 EAST 8TH STREET
CINCINNATI, OH 45202
TEL 513.241.8700
FAX 513.241.8873
www.gbbn.com

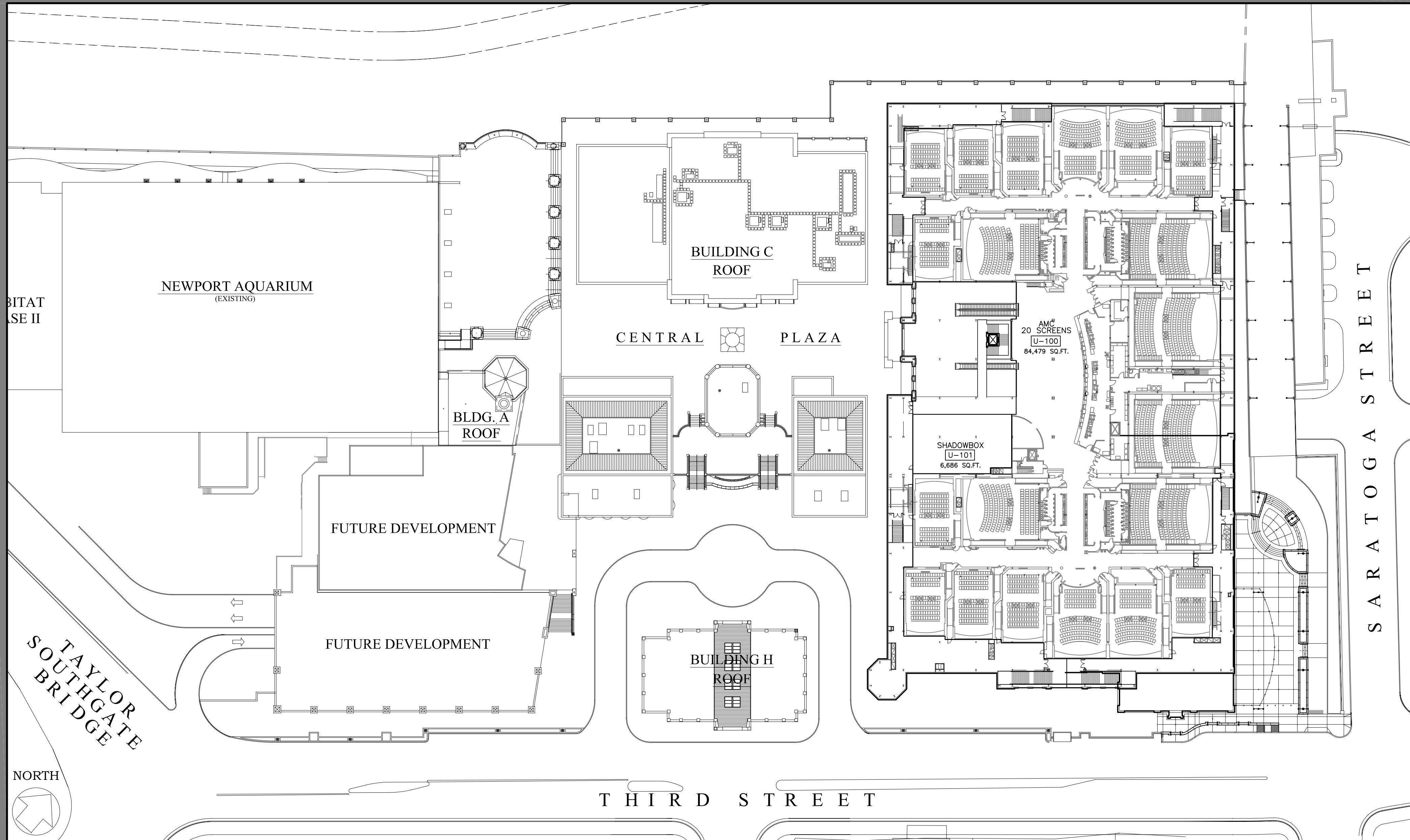

May 2011

THEATER LEVEL LEASING PLAN

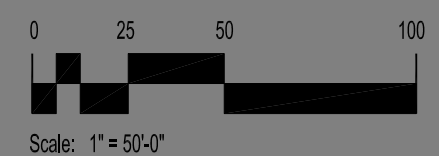

NEWPORT ON THE LEVEE
NEWPORT, KENTUCKY

MANAGEMENT OFFICE
1 LEVEE WAY SUITE 1113
NEWPORT, KY 41071
TEL 614.414.7300
FAX 859.291.7020

OWNER
THE PRICE GROUP
7979 IVANHOE AVE SUITE 550
LAJOLLA, CA 92037
TEL 858.373.2064
FAX 858.454.4230

DESIGN ARCHITECT
DEVELOPMENT DESIGN GROUP, INC.
7 ST. PAUL STREET
BALTIMORE, MD 21202
TEL 410.962.0506
FAX 410.783.0816

PROJECT ARCHITECT
GBBN ARCHITECTS
332 EAST 8TH STREET
CINCINNATI, OH 45202
TEL 513.241.8700
FAX 513.241.8873
www.gbbn.com